

WELCOME TO YOUR SMARTSTEPTM QUICK-START GUIDE

PLEASE READ THIS GUIDE BEFORE PROCEEDING

MAIN FEATURES

- ① ANTI MICROBIAL GRIP
- ② MANUAL LIGHT - CLICK FOR 30 SEC/HOLD FOR ON
- ③ FLASHLIGHT SWITCH
- ④ EMERGENCY FLASHER SWITCH
- ⑤ PILOT LIGHT - FLASHES FOR RECHARGE
- ⑥ COLOR SELECT SWITCH RED/OFF/WHITE
- ⑦ FLASHLIGHT LAMP AND LIGHT SENSOR
- ⑧ CHARGING PORT
- ⑨ SAFETY CLUTCH FOR LENGTH ADJUSTMENT
- ⑩ LIGHT PIPE FOR MAIN LIGHT - RED OR WHITE
- ⑪ NON-SKID PATENTED CANE TIP

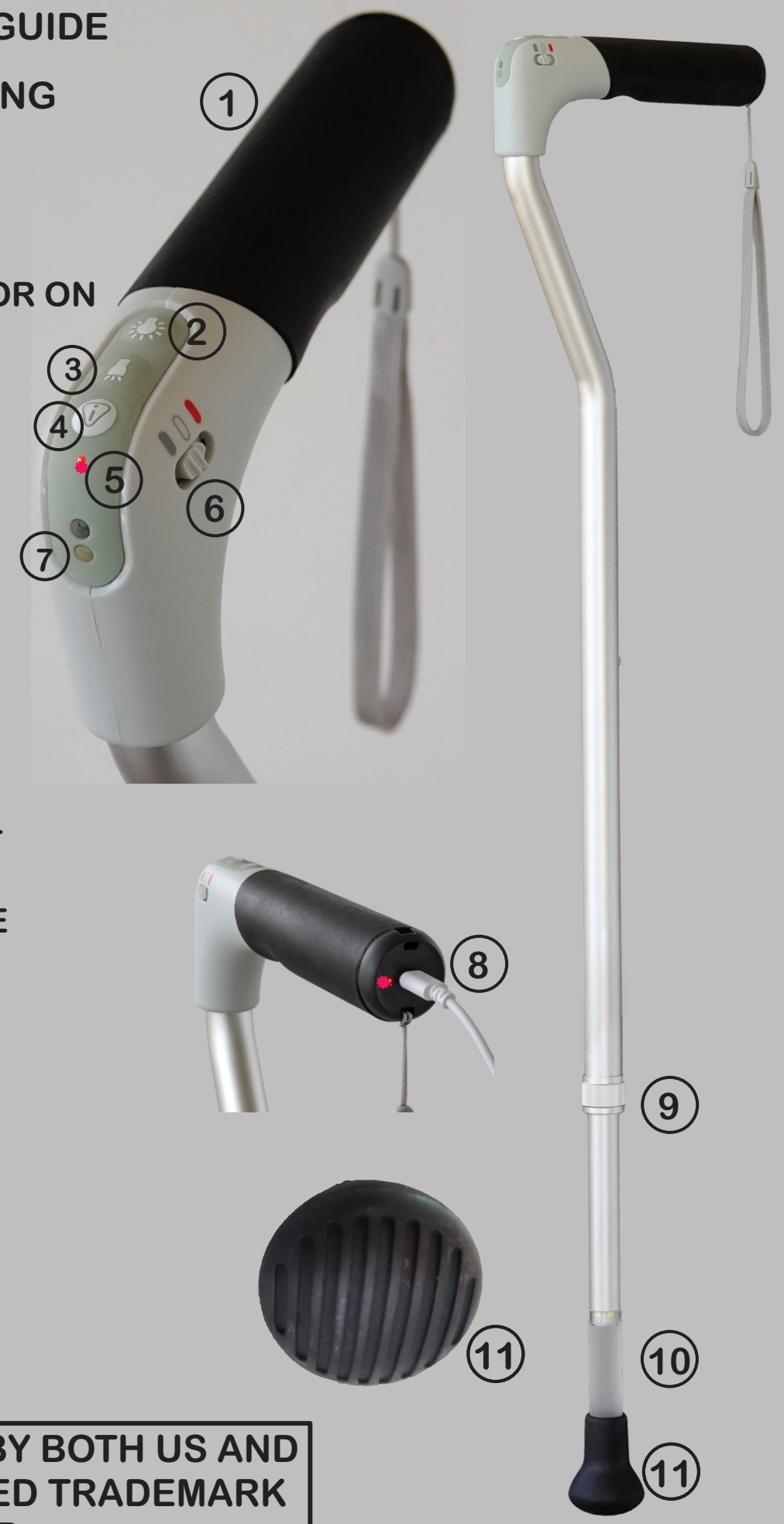

Thank you for your purchase. SMART-STEP WILL PROVIDE YOU WITH YEARS OF SERVICE. IT IS MADE WITH THE HIGHEST QUALITY MATERIALS AND HAS BEEN TESTED BY AN INDEPENDENT LABORATORY FOR LONG LIFE, STURDINESS, AND PERFORMANCE.

CAUTION!

Although your cane is not completely water proof, the light pipe at the bottom of the cane is. However do not subject your cane to exposure to water or other liquids. A typical exposure to rain does not harm the cane. Wipe the cane dry in the event of rain or snow. Clean the cane as needed with a clean damp cloth. Do not use cleaning agents with alcohol or detergents.

FOR BEST PERFORMANCE AND BATTERY LIFE, PLEASE CHARGE THE CANE FOR AT LEAST 8 HOURS BEFORE FIRST USE.

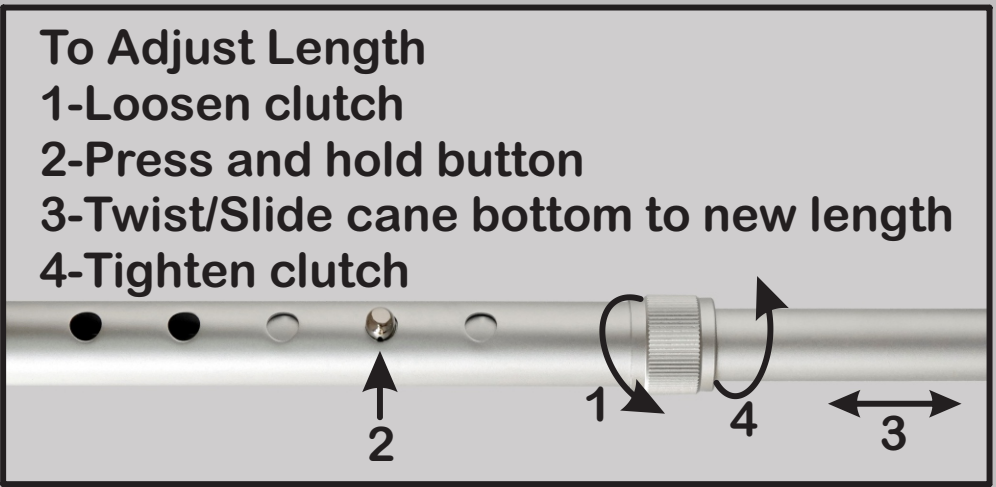

PATENT NOTICE: THIS PRODUCT IS PROTECTED BY BOTH US AND FOREIGN PATENTS. SMART STEP IS A REGISTERED TRADEMARK OF SMART MEDICAL DEVICES, L.L.P.